

BY	CHK	REVISION RECORD MODIFICATIONS	DATE	REV.
ALLEN		RELEASE TO PRODUCTION	2007,7,29	1.0

SPECIFICATION

Current Rate: 1 AMP
 Insulation Resistance: 1000mΩ Min
 Contact Resistance: 30mΩ Max
 Dielectric voltage: 500V AC for one minute
 Operation Temperature: -40°C to +105°C

MATERIAL

Insulator: Polyester, UL94v-0
 Standard: LCP
 Contact Pin: Brass
 Contact Plated: Gold Plated

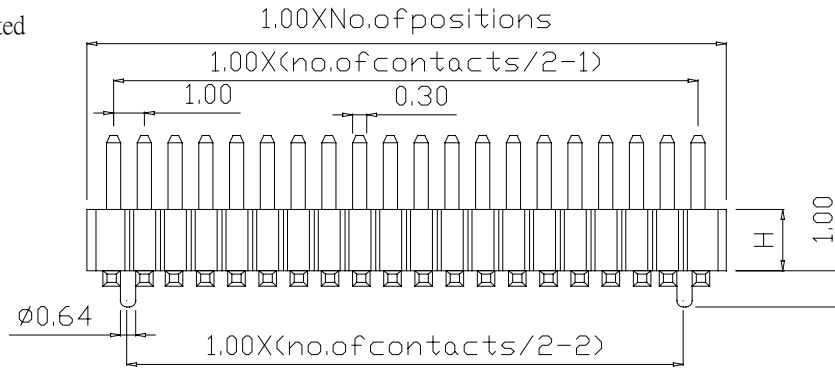
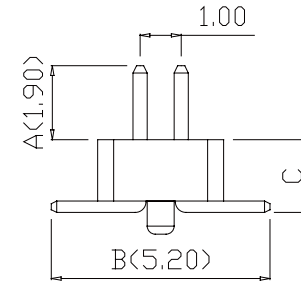
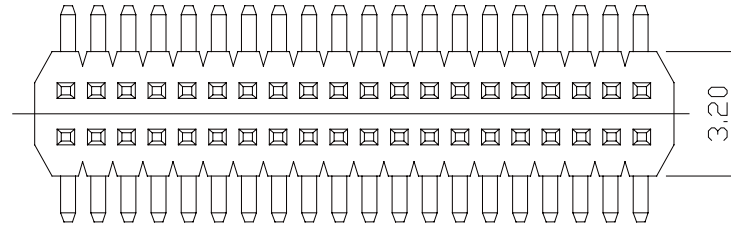

	c
H=1.0	1.30
H=1.5	1.80

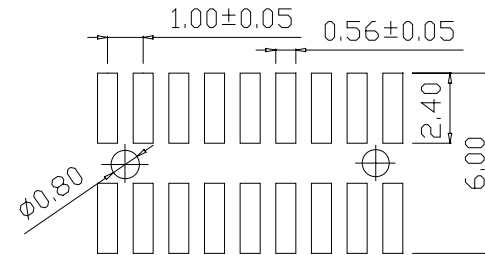

Recommended PCB Layout
 (PCB TOLERANCE ±0.05)

P	H	5	M	X	X	-	2	X	X	X	B	X	X	X	A/B/C	-	U
No. of contacts per row (01-50)							B: Black Insulator			D: w/o Peg P: With Peg		T: Tube R: Taping & Reel		U: RoHS+Nylon6T			
10: Plastic Height H=1.0mm 15: Plastic Height H=1.5mm							G: Gold flash GA: Gold 5u" GB: Gold 10u" GC: Gold 20u" GD: Gold 30u"			D: w/o cap C: With cap		Fill in Dimension For Special Design					

APPRO	CHECK	DRAWN	PART NO.	PH5MXX-2XXXBXXA/B/C-U			DESCRIPTION	
			ITEM NO.					
			DRAW NO.					
			UNIT	mm	SCALE	no		
			TOLER		NO.			
							Tel: 0769 22020068 Fax: 0769 22020069 E-mail: sales@vigortec.com	